

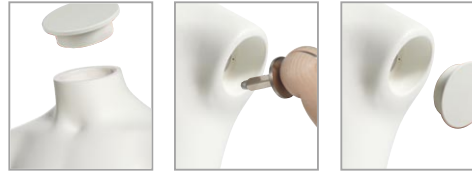

orientable head



CAP4/72.10/...(*) push and pull ARMCAP1/72.10/...(*)

(*) Optional

COLLECTION 72 ABSOLUTE VINTAGE
Product Reference Sheet / Painted

Mensurations cm / Measurements inch

Poitrine / bust	69 cm	27 $\frac{1}{8}$ "
Taille / waist	64 cm	25 $\frac{1}{4}$ "
Hanches / hips	76 cm	29 $\frac{7}{8}$ "
Hauteur / height	158 cm	5'2 $\frac{1}{4}$ "
Talon / heel	2,5 cm	1"



Confection / Clothing	EUR	FR	US
Veste / jacket	140	10a	10y
Haut / top	140	10a	10y
Pantalon / trousers	140	10a	10y
Robe / dress	140	10a	10y
Pointure / shoes		33-34	

Measurements are based on average size of the mannequins in the collection and some positions may vary in size.

Foot & calf fittings included.

7210K