

orientable head

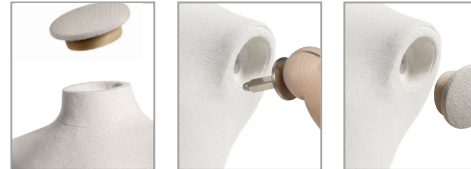

CAP4/72.4/...(\*) push and pull ARMCAP1/72.4/...(\*)



(\*) Optional

**COLLECTION 72 ABSOLUTE VINTAGE**  
 Product Reference Sheet / Fabric

Mensurations cm / Measurements inch

Poitrine / bust	57 cm	22½"
Taille / waist	52 cm	20½"
Hanches / hips	62 cm	24¾"
Hauteur / height	114 cm	3'8⅞"
Talon / heel	2,5 cm	1"



Confection / Clothing	EUR	FR	US
Veste / jacket	104	4a	4y
Haut / top	104	4a	4y
Pantalon / trousers	104	4a	4y
Robe / dress	104	4a	4y
Pointure / shoes		26	

Measurements are based on average size of the mannequins in the collection and some positions may vary in size.

Foot & calf fittings included.

**724A**